

**NOTICE TO BIDDER
CITY OF ONEIDA WATERSHED
SALE OF FOREST PRODUCTS**

Pursuant to Section 72-A of the General Municipal Law, SEALED BIDS for forest products (138 MBF and 76 cords of standing timber) on land owned by the City of Oneida, will be received by F&W Forestry Services, Inc. at 4685 Middle Settlement Rd., New Hartford, NY 13413 until **2:00 pm Tuesday, January 13th, 2026**, at which time they will be opened and read by the City's agent, F&W Forestry Services, Inc. Seller reserves the right to reject any unacceptable offer.

All blue marked trees and American beech within the sale area are for sale. The site can be accessed from Hanifin Rd. in the Town of Florence, Oneida County, N.Y. There will be a timber sale showing on Tuesday, December 30th, 2025, at 9 am. We will meet at the intersection of Hanifin Rd and Shultz Rd. Any questions about the sale, please call Lukas Myers, F&W Forestry Services, Inc. at (315) 378-3102.



TIMBER SALE NOTICE

138 MBF and 76 cords of standing timber on 56 acres

On lands owned by the City of Oneida, New York
Forty-Six Corners Tract, Town of Florence, Oneida County, N.Y.

TIMBER FOR SALE: Being offered for sale is an estimated 138 MBF (thousand board feet) of standing sawtimber and 76 cords on land owned by the City of Oneida on their Forty-Six Corners Watershed Lands. The sale area totals approximately 56 acres and can be accessed from Hanifin Rd. (see map). Timber quality and size are above average. Tree selection is a combination of prescription and marking. All of the unmarked American beech in the sale area are for sale and to be cut. The sawtimber and pulpwood trees other than beech were measured directly and marked with blue paint on the stem and stump. No other trees are to be cut. The beech pulpwood were estimated with 26 basal area factor (BAF) 10 prism plots spread across the sale area. Sawtimber volumes are reported in International ¼ inch rule and cords are reported in standard cords.

HARVESTING CONDITIONS: The exterior of the sale area is marked with two blue paint spots as well as orange flagging. There are no streams to cross, but wetlands are located to the north and south of the harvest area, so care must be taken to not excessively disturb the soft ground of the wetland buffers. The stand is marked as a thinning to harvest the mature sawtimber as well as remove the undesirable beech. The landing will be at an existing site located off Hanifin Rd and is marked with pink polka dot flagging in the field. A main skid road is flagged with blue flagging in the sale area (see maps). All main skid roads and the landing areas will need to be smoothed upon completion and left free of debris as well as appropriate BMPs in place. The Sellers Agent reserves the right to restrict harvesting if conditions are excessively wet. A sample Timber Sale Agreement can be provided upon request before bidding if necessary. Any questions about the sale, please call Lukas Myers, F&W Forestry Services, Inc. at (315) 378-3102.

TERMS: This will be a lump sum, sealed bid sale. A Timber Sale Agreement running through May 1st, 2028 will be offered. Return offers by email to Lmyers@fwforestry.com or mail to F&W Forestry Services, Inc. at 4685 Middle Settlement Rd., New Hartford, NY 13413. Mark on the lower left corner of the envelope **TIMBER BID**. All bids are due by **2:00 pm Tuesday, January 13th, 2026**. There will be no deposit necessary at the time of bidding. The winning bidder will have 30 business days from notification of acceptance of bid to provide for full payment and execute a signed contract. There will be a public showing of this timber on Tuesday December 30th, 2025 at 9 am. We will meet at the intersection of Hanifin Rd. and Shultz Rd. (see map).



City of Oneida Watershed 2026 Timber Sale Volume Report

SPECIES	DBH RANGE	# TREES	*MBF	**VOL/TREE
Black cherry	16-27"	245	51	0.208
Red maple	16-29"	234	50	0.212
Yellow birch	16-24"	112	20	0.180
Sugar maple	16-24"	57	11	0.196
White ash	14-20"	21	3	0.133
White pine	22-30"	7	3	0.493
Hemlock	18"	1	0.27	0.270

Hardwood sawtimber total =	669	134.63	MBF
Softwood sawtimber total =	8	3.72	MBF
SAWTIMBER TOTAL =	677	138.35	MBF
UNMARKED BEECH =	384	48	cords
MARKED PULPWOOD =	105	28	cords
GRAND TOTAL =	1166 trees	138	MBF and 76 cords

* - Volumes are in thousand board feet (MBF) International 1/4 inch rule

** - Volumes are in thousand board feet (MBF) International 1/4 inch rule (0.225 = 225 board feet per tree)



L. Myers 10/30/25

Oneida City Watershed 2026 Timber Sale Map

Town of Florence, Oneida County, New York

Tax Parcel ID#s: 56-1-13 & 74-1-6.1

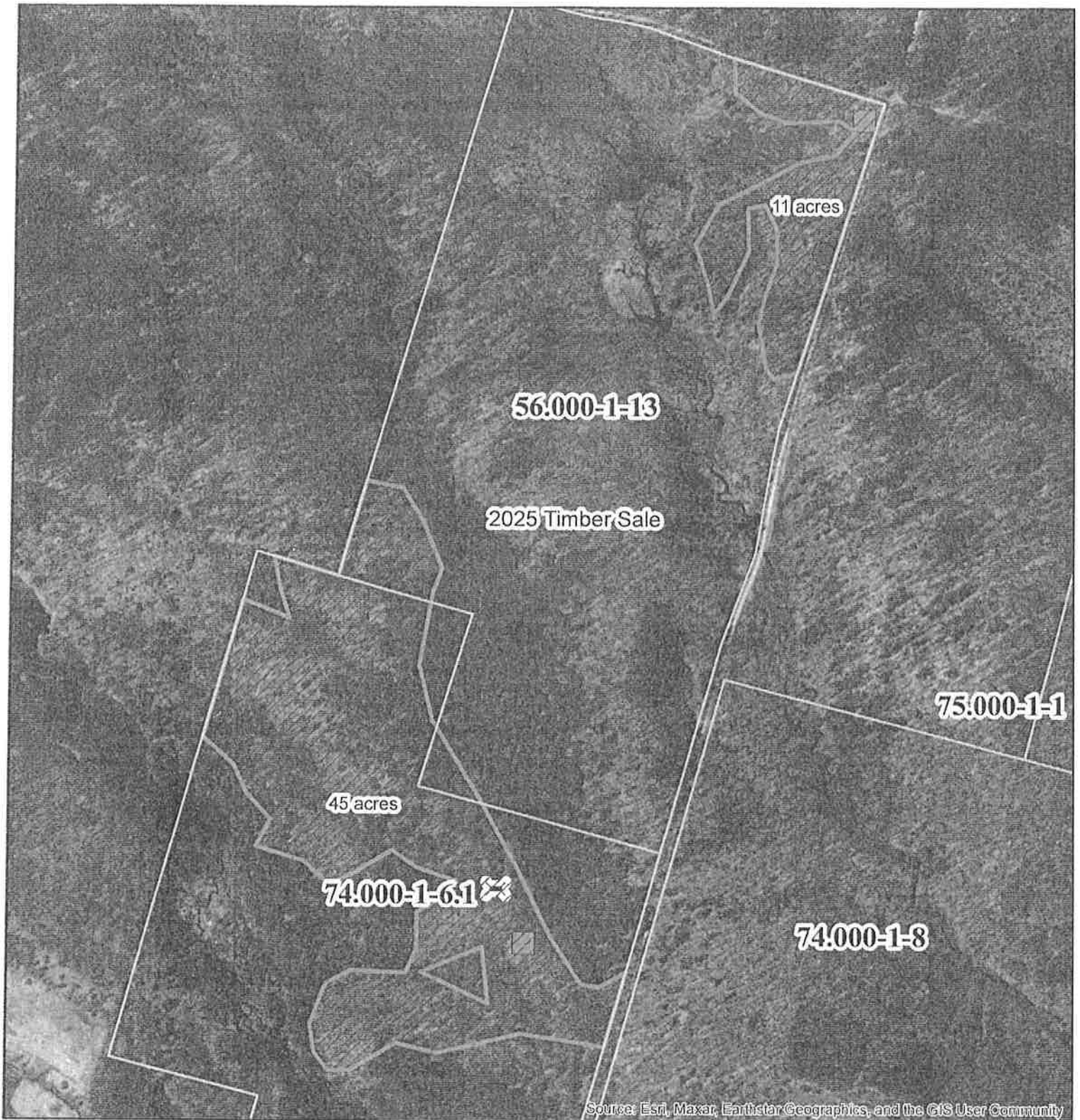

Legend

- Oneida City parcels
- 2026 marked timber
- Corduroy or mats needed

- Landing area
- Drainage crossing



Map by: L. Myers, CF
F&W Forestry Services, Inc.
Map date: 10/23/25

1,000
Feet

Oneida City Watershed 2026 Timber Sale Map

Town of Florence, Oneida County, New York

Tax Parcel ID#s: 56-1-13 & 74-1-6.1

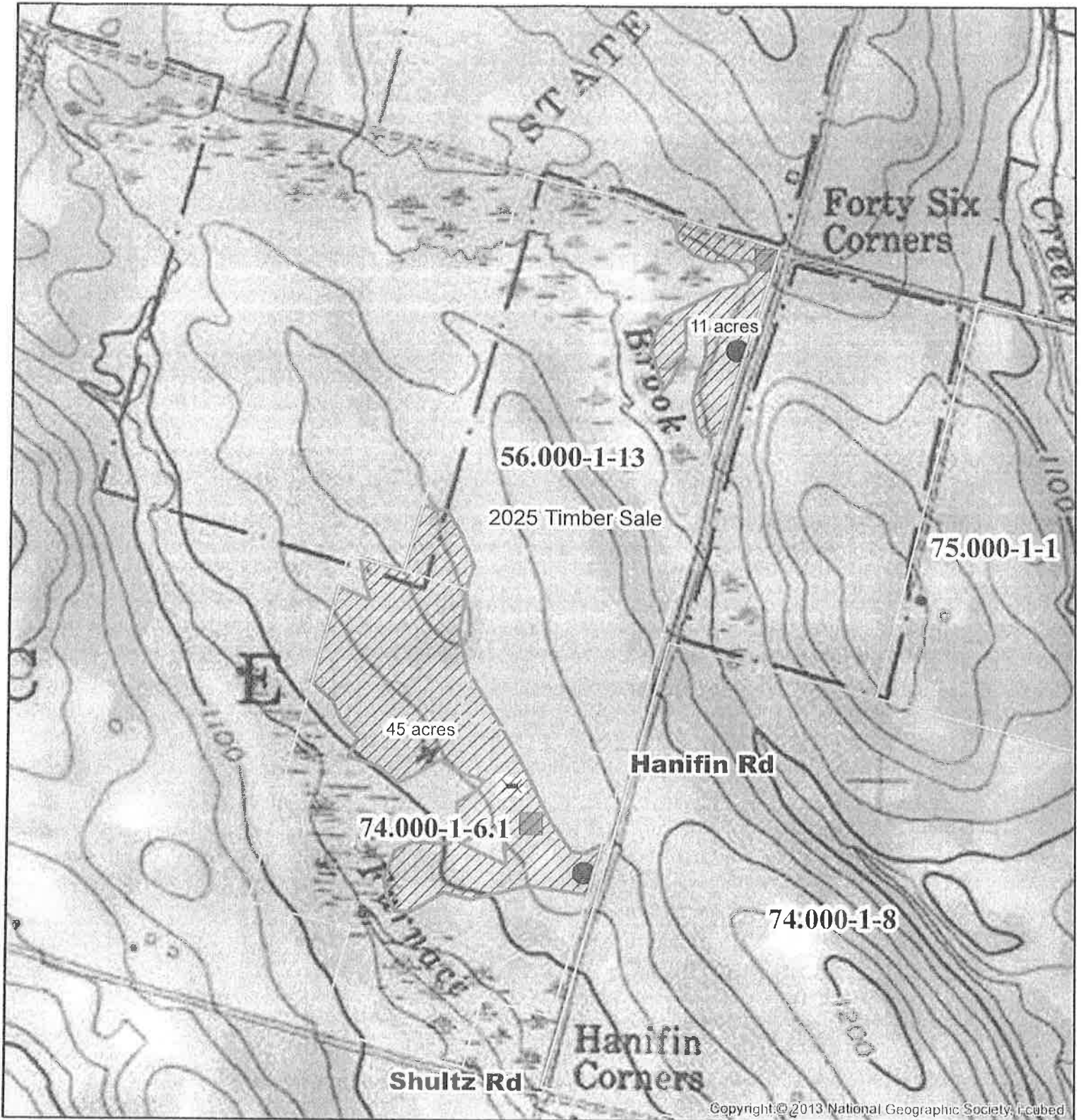

Legend

- Oneida City parcels
- 2026 marked timber
- Corduroy or mats needed

- Landing area
- Drainage crossing



Map by: L. Myers, CF
F&W Forestry Services, Inc.
Map date: 10/23/25

1,500

Feet

Oneida City Watershed 2026 Timber Sale Location Map

Town of Florence, Oneida County, New York

Tax Parcel ID#'s: 56-1-13 & 74-1-6.1

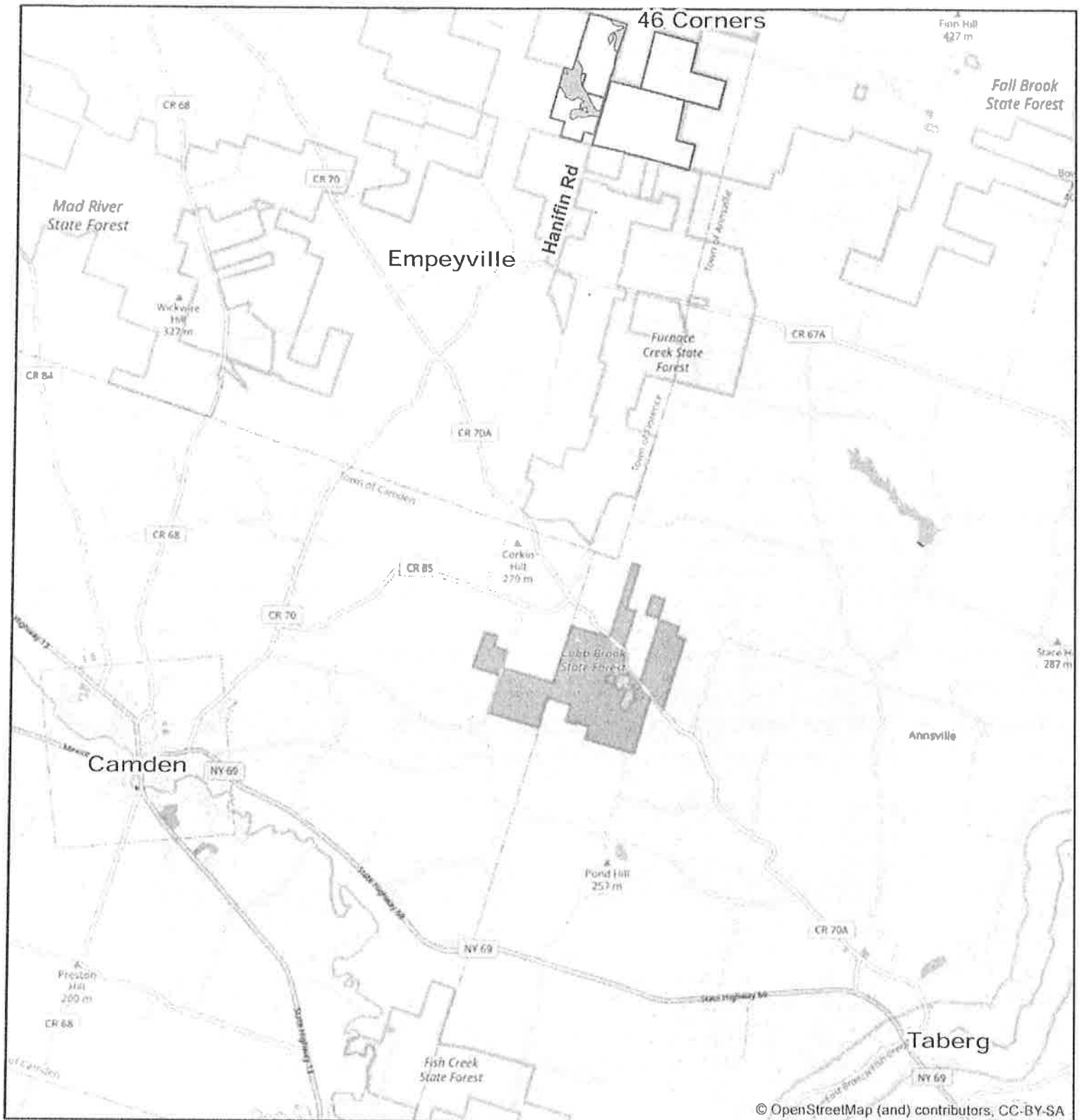

Legend

 2026 marked timber  Oneida City lands



Map by: L. Myers, CF
F&W Forestry Services, Inc.
Map date: 10/23/25

2.5

 Miles

CITY OF ONEIDA WATERSHED 2026 TIMBER BID OFFER

I _____ of _____
print name company name & address

make a sealed bid offer of \$ _____
_____ Dollars

For all timber being offered for sale marked in BLUE paint and all beech in the sale area, on watershed land owned by the City of Oneida in the Town of Florence, Oneida County, New York. I further understand that the seller makes no guarantee of volumes, quantity, or quality represented, and that I shall have 30 days from notification of acceptance of bid to make payment in full and to sign a contract. By signing this bid form, I also acknowledge that there has been, and will be no collusion with any other parties in preparing this bid as per all applicable laws. The seller reserves the right to reject any or all bids, or to reject any or all contractors to be used in the harvesting. Finally, I also agree that all operations will comply with NYSDEC and OSHA regulations and take this responsibility.

Signed – bidder Company name (if any)

Date

- Return by email to Lmyers@fwforestry.com or mail to F&W Forestry, 4685 Middle Settlement Rd., New Hartford, NY 13413.
- Mark on the lower left corner of the envelope **ATTN: TIMBER BID.**
- All bids are due by **2:00 pm Tuesday, January 13th, 2026.**
- No deposit required. Call Lukas Myers with any questions at 315-378-3102
- The winning bidder will have 30 days from notification of acceptance of bid to provide for full payment and execute a signed contract.
- There will be a timber sale showing on Tuesday, December 30th, 2025, at 9 am. We will meet at the intersection of Hanifin Rd. and Shultz Rd. (see map).

